

全自动环保除湿机

CH1800RB

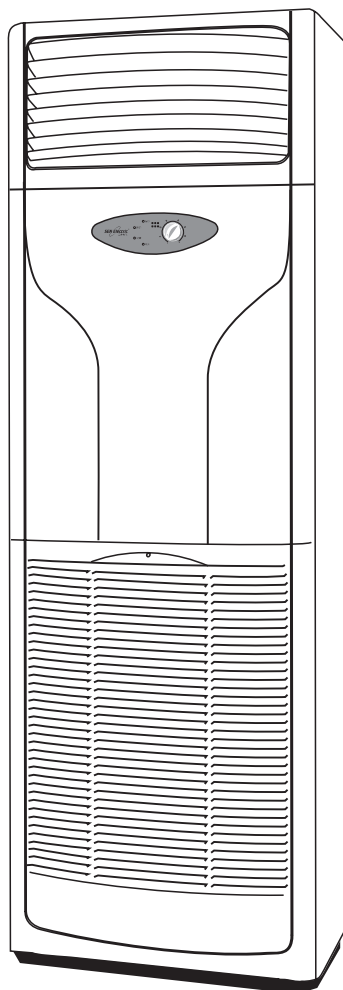

使用手册

尊敬的用户：

感谢购买本产品，请仔细阅读《使用手册》，并按照相关内容正确安装、使用、维护机器。请保存《使用手册》，以便随时查阅。为保证您获得完善的售后服务，请及时办理保修手续并保存购机凭据。

WGI Inc U.S.A.

目 录

各部位名称.....	3
机器安装及注意事项.....	4
控制显示面板.....	5
电源开关及湿度控制.....	5
运转操作.....	6
自动除霜装置.....	6
压缩机自动保护装置.....	6
自动保护报警系统.....	6
空气过滤网的清洁.....	7
电源线的维护与更换.....	8
机器清洁及维修.....	8
机器移动.....	8
一般故障排除.....	9
规格表.....	9
保修卡.....	封 三

版 权 声 明

© **WGI** 公司版权所有。本公司保留为改进产品而变更设计及规格的权利，恕不另行通知。

由于产品的改进，您所购买的产品可能与使用手册中的介绍不完全一致，谨此致歉。

如有任何印刷错漏或在翻译中可能产生的误差，本公司不承担由此产生的后果。

各部位名称

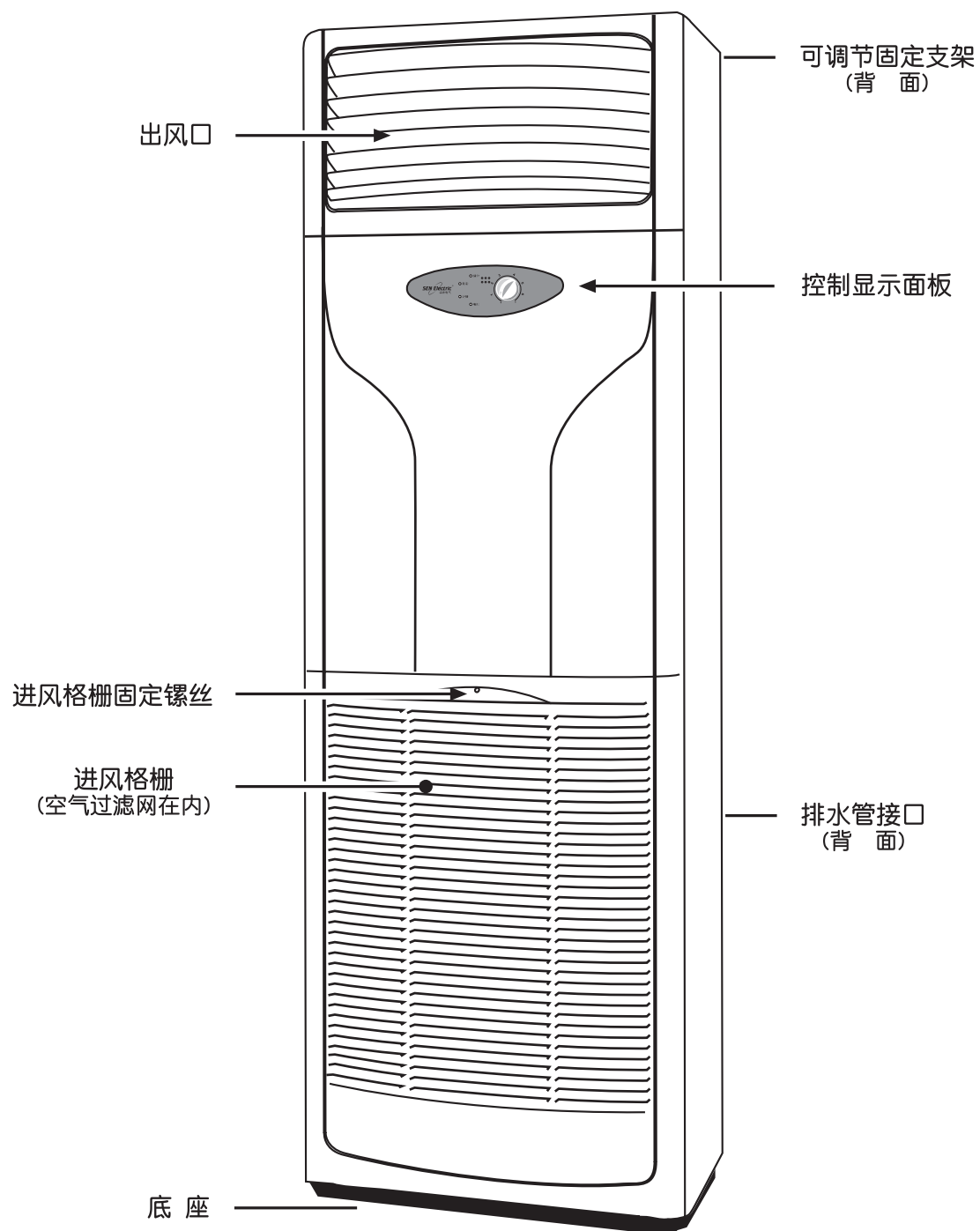

机器安装及注意事项

- 1、本机仅限室内使用，适用环境温度为：5~35℃。

机器应远离热源，防止水或其他液体侵触，不要在易燃易爆气体、腐蚀性化学品污染及灰尘严重的环境使用。

- 2、本机仅适用于单相 220V AC/50Hz 电源，使用场所的电源电压、电线配置及电线配置及电源开关、插座均应符合用电安全国家标准。

如果使用场所电源的电压不稳定，应采取有效的稳压措施，以免机器受到损坏，甚至引起火灾等严重事故。

- 3、每台机器应设专线电源及专用电源插座并可靠接地，还应配置专用的电气保险装置。切勿多台机器或与其它电器共用一个电源转接器，也不要使用带延长线的普通电源转接器，以免机器受到损坏，甚至引起火灾等严重事故。

- 4、放置机器的地面应平坦坚固，机器放置平稳后，可利用机背顶部可调节支架与墙壁固定，以防止倾倒、噪音或其它异常情况，影响正常使用。

- 5、机器进、出风口前方应有 1 米以上的空间且无遮蔽物，以利空气循环流通，发挥除湿效能。请勿将杂物遗留在进、出风口内，以免机器受到损坏。

- 6、本机除湿量较大，应注意将随机配置的塑料水管套紧在排水管接口上，水管应成斜度下垂且勿折曲，与之连接的排水管道应低于排水接口，以保证排水顺畅。

- 7、机器运转中，请不要通过拔下电源线插头强行停止机器运转，以免机器受损甚至引起触电、火灾等严重事故。

- 8、机器在低温或低湿环境下工作时，除湿量明显减少甚至不除湿，这属于正常现象。

- 9、机器使用场所无人时请关机，以避免其它因素引起意外事故。

警示：请提供符合标准的电源及电气配件并由具备资格的电工负责机器的安装。

否则机器将不能正常运转并可能受到损坏，甚至引起短路、触电、火灾等严重事故。

控制显示面板

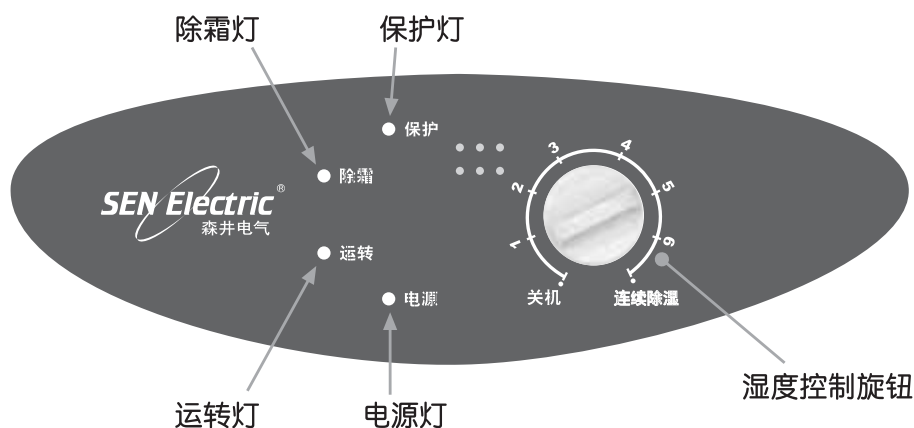

电源开关及湿度控制

- 1、操作控制旋钮在“关机”的位置上，电源未接通，旋钮在“1”至“6”数字以及“连续除湿”的位置上，电源接通，机器运转。
- 2、通过设定操作控制旋钮数字可选择合适的环境相对湿度控制范围；湿度控制系统可感应环境相对湿度而自动控制开启/关闭压缩机运转，当环境相对湿度达到设置范围时，机器自动停止运转；当环境相对湿度超出设置范围时，压缩机启动运转，机器开始除湿。
- 3、设定操作控制旋钮数字自动控制环境相对湿度的参考范围：
 - 数字“1”：85%~75%RH； • 数字“2”：70%~60%RH；
 - 数字“3”：60%~50%RH； • 数字“4”：50%~40%RH；
 - 数字“5”：45%~35%RH； • 数字“6”：40%~30%RH。
- 4、设定操作控制旋钮在“连续除湿”的位置上，机器连续运转除湿。

运转操作

- 1、请使用独立的、符合用电安全国家标准的电源插座。
 - 劣质的电源插座、多台机器或与其它电器共用一个电源转接器，以及其它不规范的电源连接方式，均容易使机器受到损坏甚至引起火灾等严重事故。
- 2、确认旋钮在“关机”位置上再将电源插头插入电源插座，电源灯亮起。
- 3、湿度控制旋钮在“关机”的位置上，电源未接通，将旋钮顺时针方向设置在需要的数字或连续除湿的位置上，运转灯亮起，机器运转除湿。
- 4、湿度控制旋钮在“关机”位置，机器停止运转。

自动除霜装置

- 1、自动除霜装置由微电脑控制，当低温导致蒸发器结霜时即开始运转除霜。
(此时，其它功能需稍候除霜完成后才能操作。)
- 2、控制显示面板上的除霜灯闪烁表示机器在自动除霜中，熄灭表示除霜完成，恢复除湿功能。
- 3、机器正在除霜时不能关机，以免除霜水淌出机外。

压缩机自动保护装置

- 1、压缩机自动保护装置可控制压缩机在开机或再次启动时延时**3**分钟才启动运转，避免压缩机在电源不正常或频繁开/关机时可能受到的损坏，机器停机后不必等候**3**分钟即可再次开机，从而节省用户时间。
- 2、控制显示面板上的运转灯闪烁表示待机状态，闪烁停止并亮起表示压缩机已经启动运转。

自动保护报警系统

当出现电源不正常、环境温度过高、管路压力或压缩机负荷过大、压力感应器或除霜感应器失效等异常情况时，自动保护报警系统启动，机器停止工作，控制显示面板上的保护灯及除霜灯同时闪烁并间歇发出“哔、哔”声，显示机器异常，此时应立即关机并断开电源，待检查、排除故障后方可接通电源，重新启动机器运转。

空气过滤网的清洁

空气过滤网上附着过多灰尘会影响空气流通，使除湿效率下降，甚至损坏机器，为此，请经常清洁：

- 1、先关机后拔下电源线插头。
- 2、用螺丝刀拧开进风格栅的固定螺丝，拆下进风格栅，取出滤网。
- 3、用软布、毛刷或吸尘器清除灰尘，如较脏，可用柔性洗涤剂加水清洗后晾干。
- 4、将干净的空气过滤网装回进风格栅，再将进风格栅放置定位，拧紧固定螺丝。

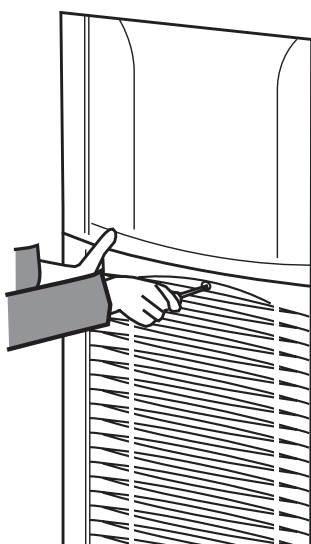

拧开固定螺丝

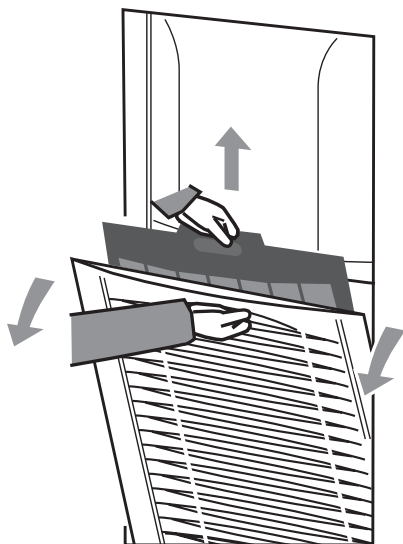

拆下进风格栅，取出滤网

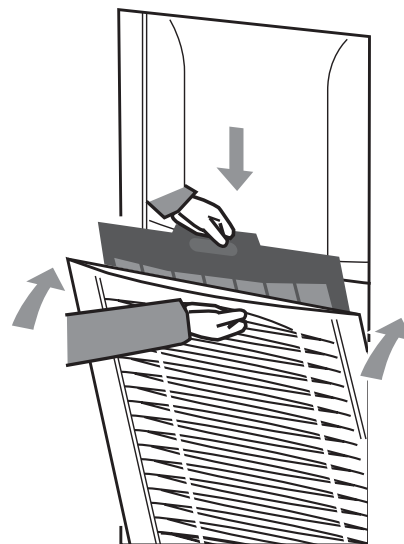

放回滤网，固定进风格栅

警 示： 机器必须安装空气过滤网方可运转，否则会使内部器件污脏受损，引起故障。

电源线的维护与更换

电源线受到损坏，会导致机器受损及漏电、短路甚至引起火灾等严重事故，为此应避免电源线受到强力拉扯、折叠、重压或鼠咬、化学物腐蚀等损害。当电源线受损时，请即关机，待出风口完全停止送风后，将插头从插座上拔下后与授权维修中心(站)或供应商联系更换新品，请不要自行拆卸更换非本机专用电源线。

机器清洁及维修

- 1、机器清洁或维修前，请先关机后拔下电源线插头。
- 2、进、出风口容易沾染灰尘，请经常用软棉布擦拭。
- 3、请用较柔性的清洁剂清洁机体并用软棉布擦拭。
- 4、请不要用水冲洗，以免机器受到损坏。
- 5、机器出现故障不能排除并确认需要维修时，请与授权维修中心(站)或供应商联系，请不要擅自拆卸机器维修。

机器移动

- 1、机器移动前，请先关机后拔下电源线插头。
- 2、小心轻放，避免碰撞，切勿平放或倒置。

一般故障排除

故障情况	故障原因	处理方法
机器不能运转	1、停电 2、电源不正常	恢复供电 修复电源
除湿效果欠佳	1、过滤网阻塞 2、门窗未关 3、有遮蔽物阻碍进/出风口	清洁过滤网 关闭门窗及通风口 清除遮蔽物使空气流通
噪音太大	1、机器放置不平稳 2、过滤网阻塞	将机器重新放置好 清洁过滤网
水流到地面	1、排水管安装不良 2、排水管脱落 3、排水管堵塞	将排水管成斜度下垂且勿折曲 重新套紧排水管 清除堵塞物

当故障不能排除并确认需要维修时，请与授权维修中心(站)或供应商联系，请不要擅自拆卸机器维修。

规格表

型 号	CH1800RB
除 湿 量	7.5 kg/h , 180 L/d (30℃, 80%RH)
空气循环量	1600 m ³ / h
适用环境温度	5~35℃
电 源	220 V AC / 50 Hz
额定输入功率	2600 W
额定输入电流	12 A
制 冷 剂	R22 , 950 g
净 重	77 kg
外形尺寸	H1900 • W600 • D380 mm

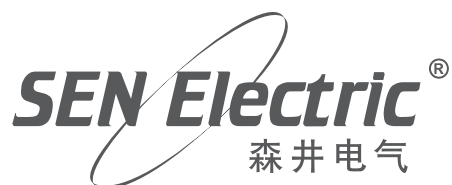

AUTOMATION DEHUMIDIFIER

CH1800RB

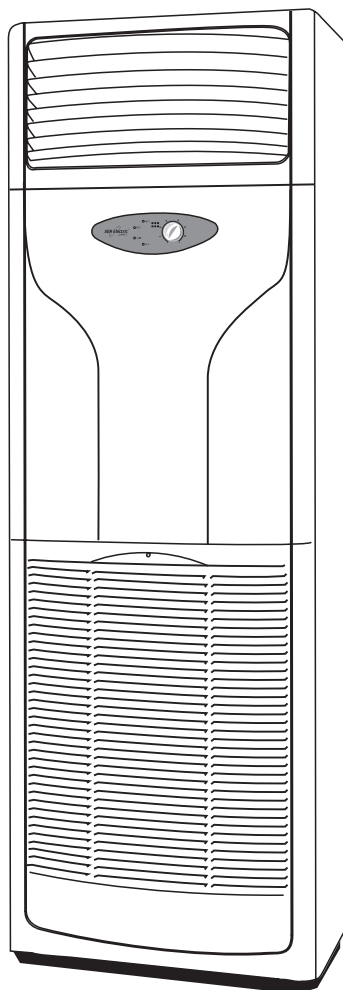

USER MANUAL

Dear customer:

Thank you for buying this product. Please read the manual carefully before operating. Follow the instructions to use and maintain the unit, and keep it for future reference. Please finish the service registration for obtaining well customer service afterwards.

WGI Inc U.S.A.

Contents

The Components.....	3
Installation and notice.....	4
Control Panel.....	5
Power On/Off and Humidity Control.....	5
To Operate.....	6
Defrosting Control.....	6
Compressor Self-protection.....	6
Automatic protection alarm system.....	6
Cleaning the air filter.....	7
To Replace Power Cord.....	7
To Clean the Unit.....	8
To Move.....	8
Troubleshooting.....	9
Specifications.....	9
Product Service Card.....	Back

Copyright statement

All rights reserved by **WGI** Corporation. This company retains the rights to improve the product and to change the design and/or the specifications, without further informing.

As a result of product improvement, the product that you purchase possibly incompletely consistent with the contents of the User Manual. We apologize sincerely if it happens.

If there are any printing errors, omissions or translation errors, the company doesn't undertake the consequence it produces.

The Components

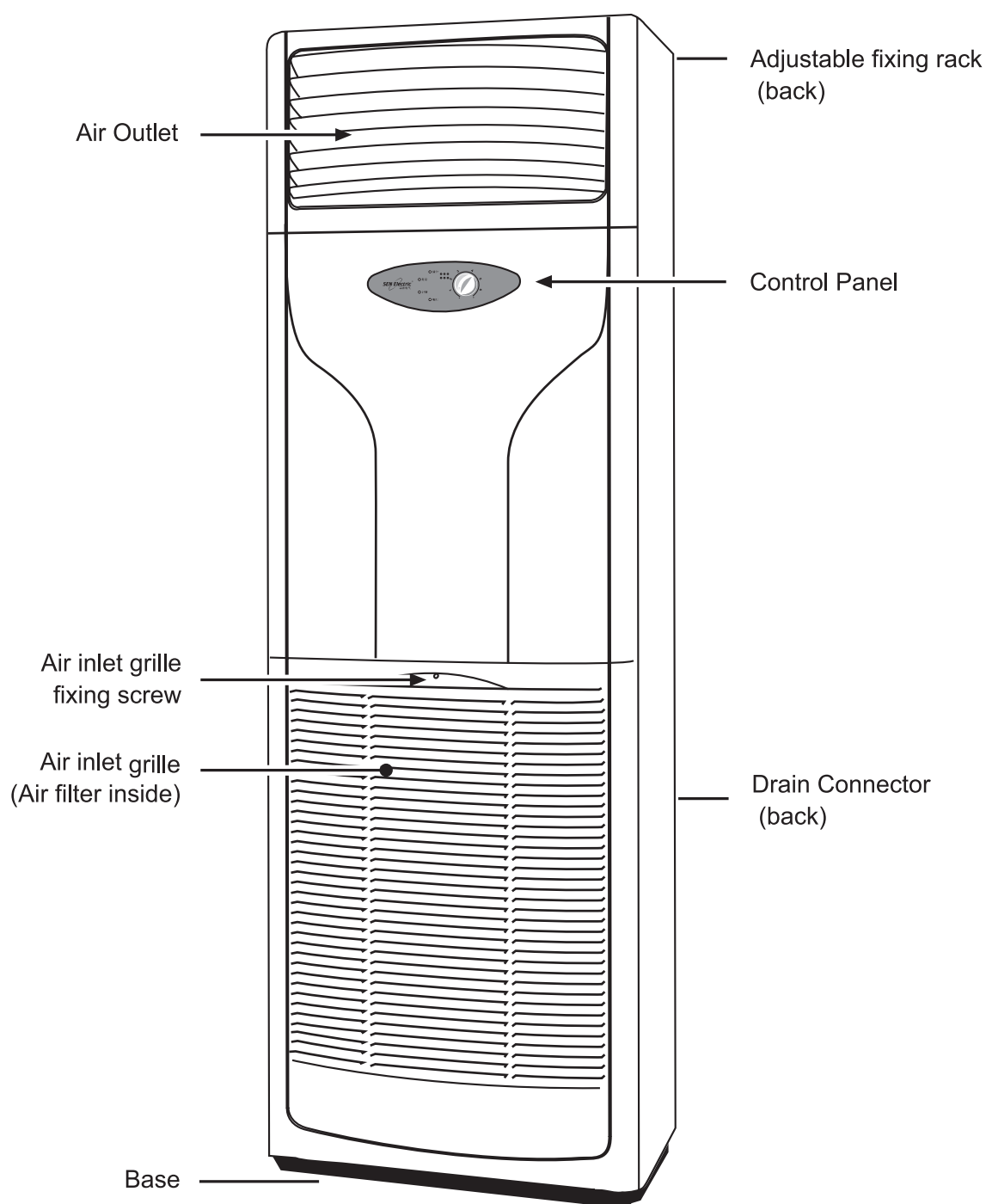

Installation and notice

1. The unit is only for indoor use within ambient temperature of 5~35℃. In order to avoid danger, the unit should be far away from heat, explosive gas, plenty of dusts and chemical environment.
2. Rated power supply: 220V AC / 50Hz only. The receptacle should be separate and qualified.
If the voltage of the power source is unstable, please use a voltage regulator in order to prevent the unit from damage, even serious accident of causing fire.
3. Each unit should use a specific power line, specific power plug and socket, and reliable earthing. A suitable power protector is also required. Share with other electric in one socket, or use a socket with extension cord, will damage the unit, even cause fire and other accident.
4. Please set the machine on flat and hard ground to avoid water leaks, loosen, noise or other abnormal situation.
5. There should be no obstacle in the space of 1 meter from the outlet and inlet. Don't let anything in the outlet and inlet in order to air circulation and protect machine.
6. The unit discharges much water. Be noticed to tighten the plastic drain hose on the drain connector. The drain hose should lead downward without any sharp bend to assure a smooth draining.
7. Do not pull off the power line to stop the unit when operating, that could damage the unit, even cause electric shock or fire.
8. It is normal that the dehumidification capacity seems low when the unit works in lower temperatures.
9. Do not leave unit running unattended for long periods of time as a safety precaution.

Warning: Please conform the standard power source and qualified technicians for installation of the machine. Otherwise, the machine will not be able to work normally, or even caused damage, short circuit, electric shock, fire or other serious accidents.

Control Panel

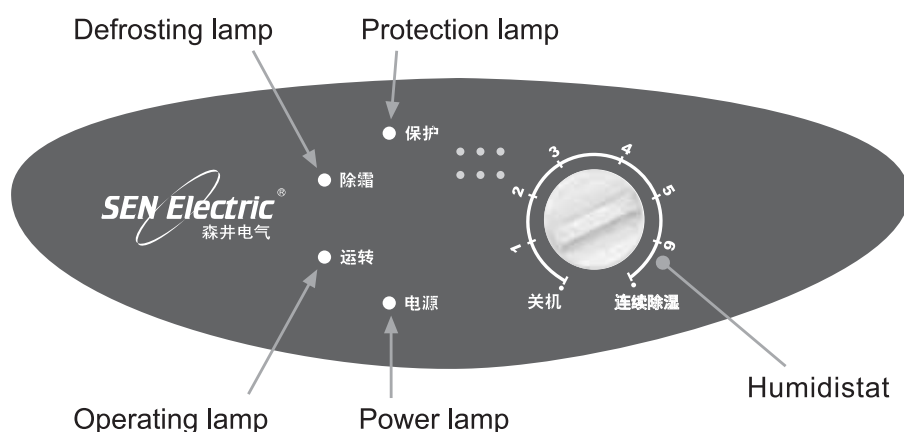

Power On/Off and Humidity Control

1. When the humidistat is set to "Off", the unit keeps power off. From "1" to "6" and "continuous dehumidifying" stand for power on.
2. The humidistat is to detect humidity in the air, and to control the unit on and off according to the position "1"~"6" as selection of appropriate humidity. The machine stops when the air humidity is reduced to the range. The machine restarts to dehumidify if the air humidity exceeds the range.
3. The approximate humidity control ranges are:
 - "1" : 85%~75%RH; • "2" : 70%~60%RH;
 - "3" : 60%~50%RH; • "4" : 50%~40%RH;
 - "5" : 45%~35%RH; • "6" : 40%~30%RH.
4. The unit will keep running when the humidistat is set at "continuous dehumidifying".

To Operate

1. Please use a qualified receptacle.
It is easy to cause fire or other disasters when using an unqualified receptacle or sharing with other appliances.
2. Make sure to set the knob at "Off" before plugging the cord to the power source.
3. The machine is power-off when the control knob is set at "Off". Turn the knob clockwise to a number or the "continuous" position till the operating lamp lights and the machine runs. Set the knob to a suitable position so the machine will operate automatically for the desired humidity.
4. The machine will stop when the control knob is set at "Off". Please unplug the power cord if the machine is not to be used for a long time.

Defrosting Control

1. An automatic defroster controlled by a microcomputer will start defrosting when low ambient temperature causes the evaporator getting icing. (Other functions cannot be operated until the defrosting completes.)
2. The defrosting lamp on the control panel blinks to indicate that the machine is in automatic defrosting. The defrosting lamp extinguishes when the defrosting is completes, and the machine restores to dehumidification.
3. The machine cannot be turned off when defrosting.
4. The unit performs less dehumidification when working in a lower ambient temperature. This is a normal phenomenon.

Compressor Self-protection

1. The unit performs less dehumidification when working in a lower ambient temperature. This is a normal phenomenon.
2. The operation lamp on the control panel blinks to indicate that the compressor is waiting to run. The operation lamp turns into steady lights to indicate that the compressor already starts operation.

Automatic protection alarm system

When the power source is abnormal, the environment temperature is too high, the line pressure or the compressor load exceeds, or the pressure sensor or temperature fails and so on, the automatic protection alarm system starts, the machine stops, the protection lamp and the defrosting lamp on the control panel blink simultaneously and intermittent "beeps" are generated. This indicates that the machine is abnormal. Please unplug the machine, call for inspection and/or repairing before restarting the machine.

Cleaning the filter

When the air filter is covered with plenty of dusts, the air circulation and dehumidification efficiency will drop; the machine may even be damaged. Therefore, please frequently clean the filter:

1. Turn off the unit and unplug the power cord.
2. Use a screw driver to remove the air inlet grille fixing screw, release the air inlet grille and take out the air filter.
3. Clean the filter with a soft cloth, soft brush or vacuum cleaner. If necessary, use soft detergent and water to wash tenderly and then dry it.
4. Restore the clean air filter in the air inlet grille. Reinstall the air inlet grille in place with the fixing screw.

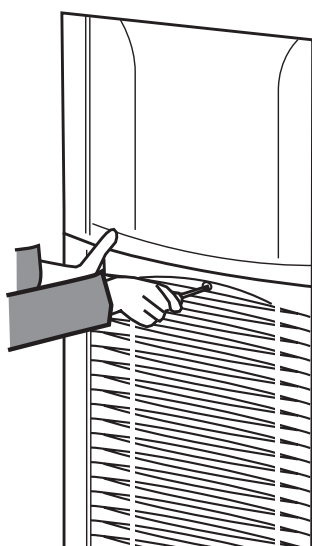

Remove the fixing screw

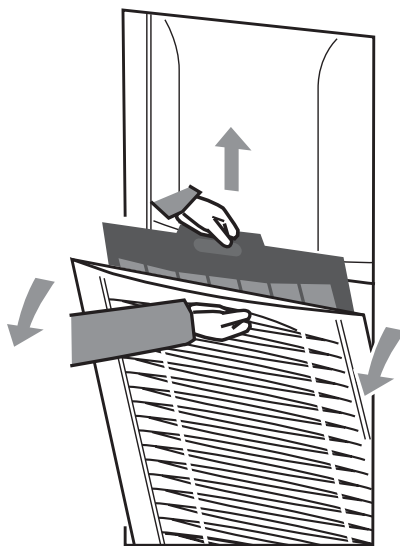

Release the air inlet grille,
take out the filter

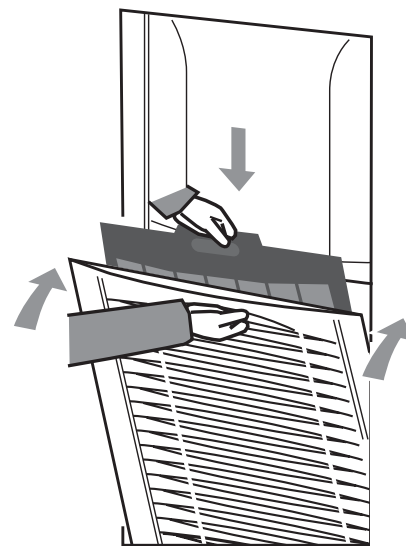

Restore the air filter and
the air inlet grille

Warning: The machine must have the air filter installed before operating. Otherwise, the internal components will get dirty and be damaged or malfunctioned.

To Replace Power Cord

If the power cord is damaged, it will cause danger of short circuit or harms. Please do not pull strongly, twist, mice bite or press the cord.

If the power cord is damaged, turn off and unplug the machine. Please contact your dealer, do not try to repair it yourself or use any other unqualified power cord on the unit.

To Clean the Unit

1. Before cleaning or maintaining, turn off the unit and unplug the cord.
2. The air inlet and outlet may gather dust easily, please clean it often with a soft cotton cloth.
3. Please use soft detergent to clean the unit.
4. In order to avoid damage, do not wash the machine with pouring water.
5. Please contact your dealer if the unit has a problem. Do not try to repair it yourself.

To move

1. Before moving the machine, first turn it off and unplug.
2. Place it carefully, avoid collision, and never lay it down or turn it over.

Troubleshooting

Problem	Cause	Remedy
Fails to run	1. Power failure 2. The power connection is abnormal	Check the power Check the power and connection
Performance Decreased	1. Filter is blocked 2. Room windows opened 3. Obstacles in outlet or inlet	Clean the filter Close room windows and doors Clean the obstacles
Noise occurs	1. Unstable setting of unit 2. Filter is blocked	Reset the unit Clean the filter
Water drips on floor	1. Poor drain hose connection 2. Drain hose looses 3. Drain hose is clogged	Lead the hose smoothly down to the drain with no sharp bends Well connect the hose Clean the clog

Please contact your dealer if there is still a problem. Do not try to repair it by yourself.

Specifications

MODEL	CH1800RB
Dehumidification	7.5 kg/h , 180 L/d (30℃, 80%RH)
Air circulation	1600 m ³ / h
Working Environment	5~35℃
Power Source	220 V AC / 50 Hz
Wattage	2600 W
Current	12 A
Refrigerant	R22 , 950 g
Net Weight	77 kg
Product Dimensions	H1900 • W600 • D380 mm